

1	11.25	Tel Que Construit	MM	MM	LD
0	01.25	Emission originale	MM	MM	LD
Rév	Date	Désignation	Dess.	Vérif.	Approb.

 <div>395 rue Édouard Branly Notre Dame de Gravenchon 76330 Port-Jérôme-sur-Seine Tel : 02.32.84.58.58 www.i-e-s.fr</div>	Date de création
	01.2025
	N° Affaire
	0P02336



RAFFINERIE DE
PORT-JEROME
GRAVENCHON



ENTREPOTS 1/2 CWM
DETECTION INCENDIE

NOM DU FICHIER:	KS01264C	F°01
-----------------	----------	------

Ce plan est la propriété d'IES, il ne peut être
utilisé, reproduit, communiqué ou dupliqué sans
autorisation préalable

ENTREPOT 1

ENTREPOT 2

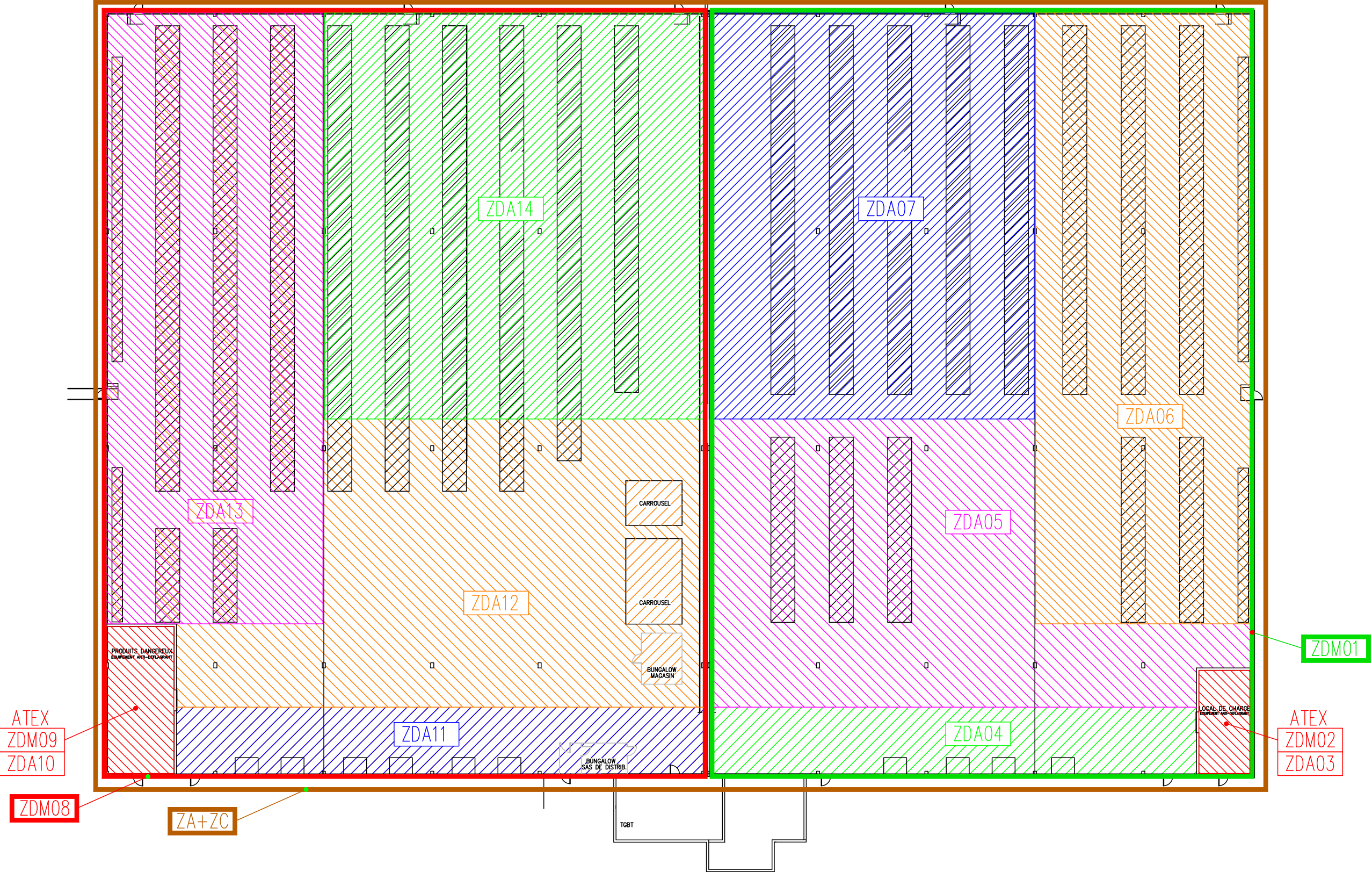

N° DAO		KS012167C			ENTREPOTS CWM			
REV	DATE	DESIGNATION	PAR	VISA	DETECTION INCENDIE PLAN DE ZONE ENTREPOT			
0	01.25	EMISSION ORIGINALE	IES	LD 0P02336				
1	11.25	TEL QUE CONSTRUIT	IES	LD 0P02336				
					N°		F°04	Rev 1

RDC HALL + TGBT

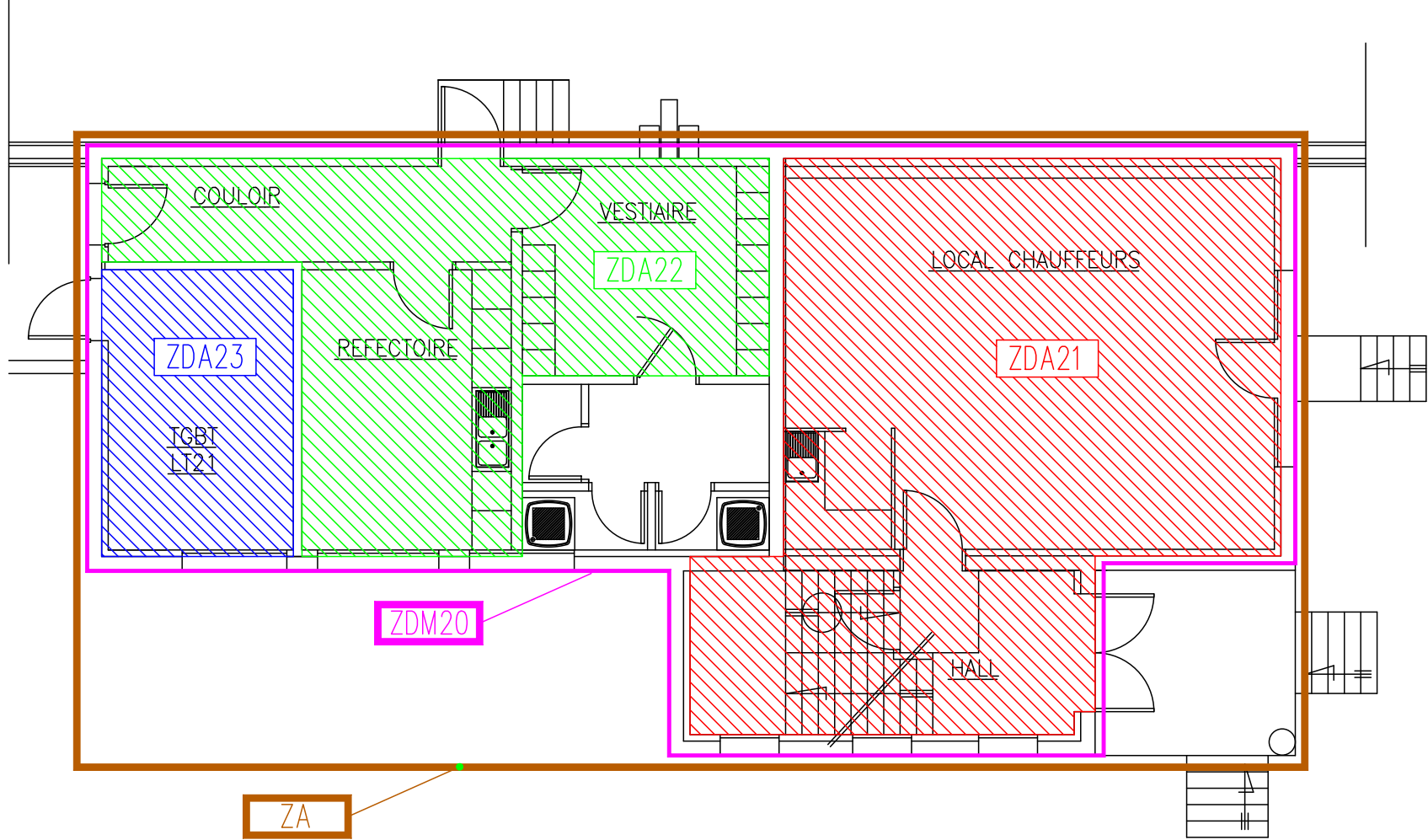

N° DAO		KS01268C			ENTREPOTS CWM		
REV	DATE	DESIGNATION	PAR	VISA	DETECTION INCENDIE RDC HALL + TGBT PLAN DE ZONE		
0	01.25	EMISSION ORIGINALE	IES	LD 0P02336			
1	11.25	TEL QUE CONSTRUIT	IES	LD 0P02336			
					N°	F°05	Rev 1

1ER ETAGE – BUREAUX

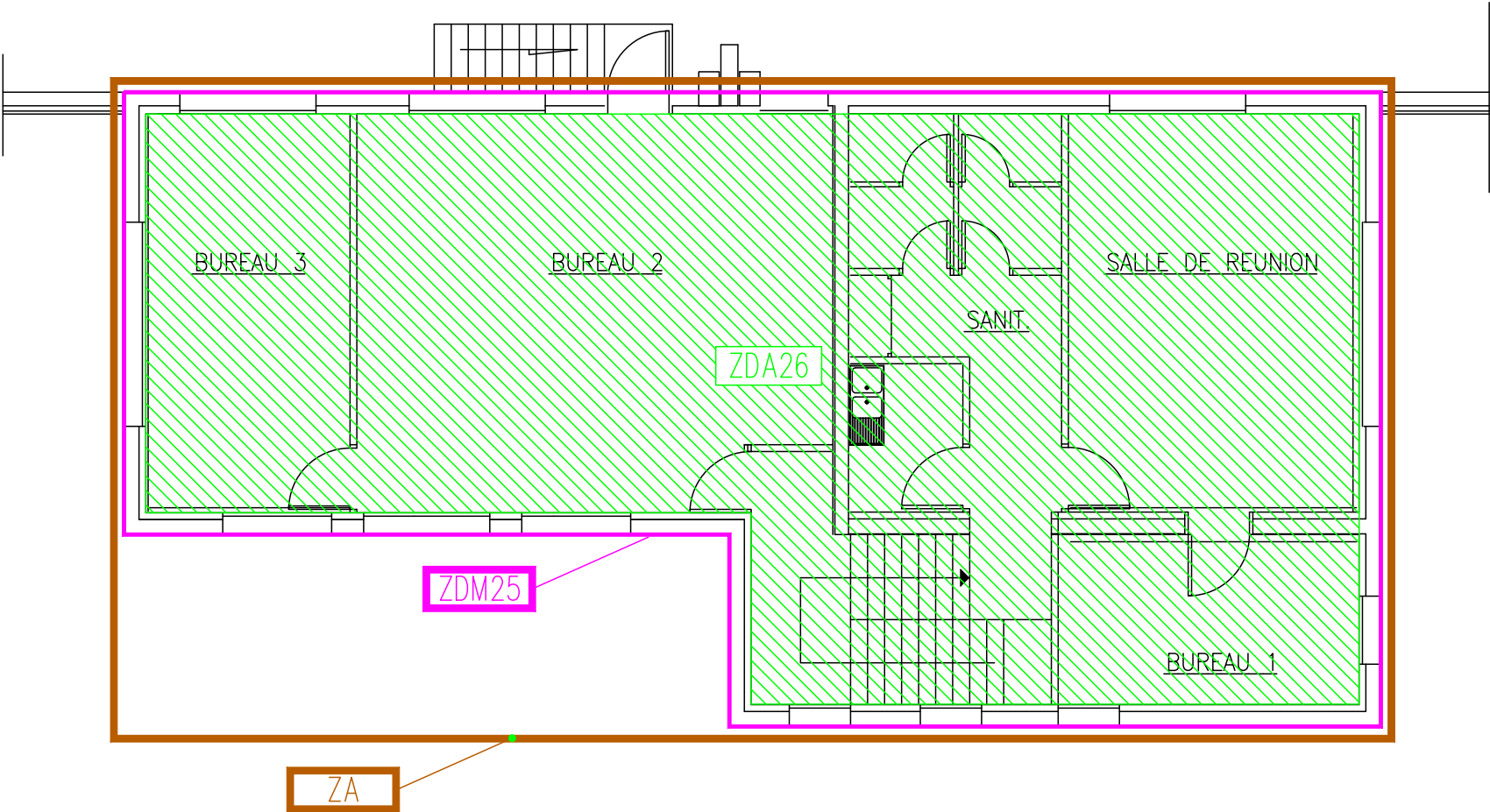

N° DAO		KS01269C			ENTREPOTS CWM		
REV	DATE	DESIGNATION	PAR	VISA	DETECTION INCENDIE 1ER ETAGE – BUREAUX PLAN DE ZONE		
0	01.25	EMISSION ORIGINALE	IES	LD 0P02336			
1	11.25	TEL QUE CONSTRUIT	IES	LD 0P02336			
					N°	F°06	Rev 1

ENTREPOT 1

ENTREPOT 2

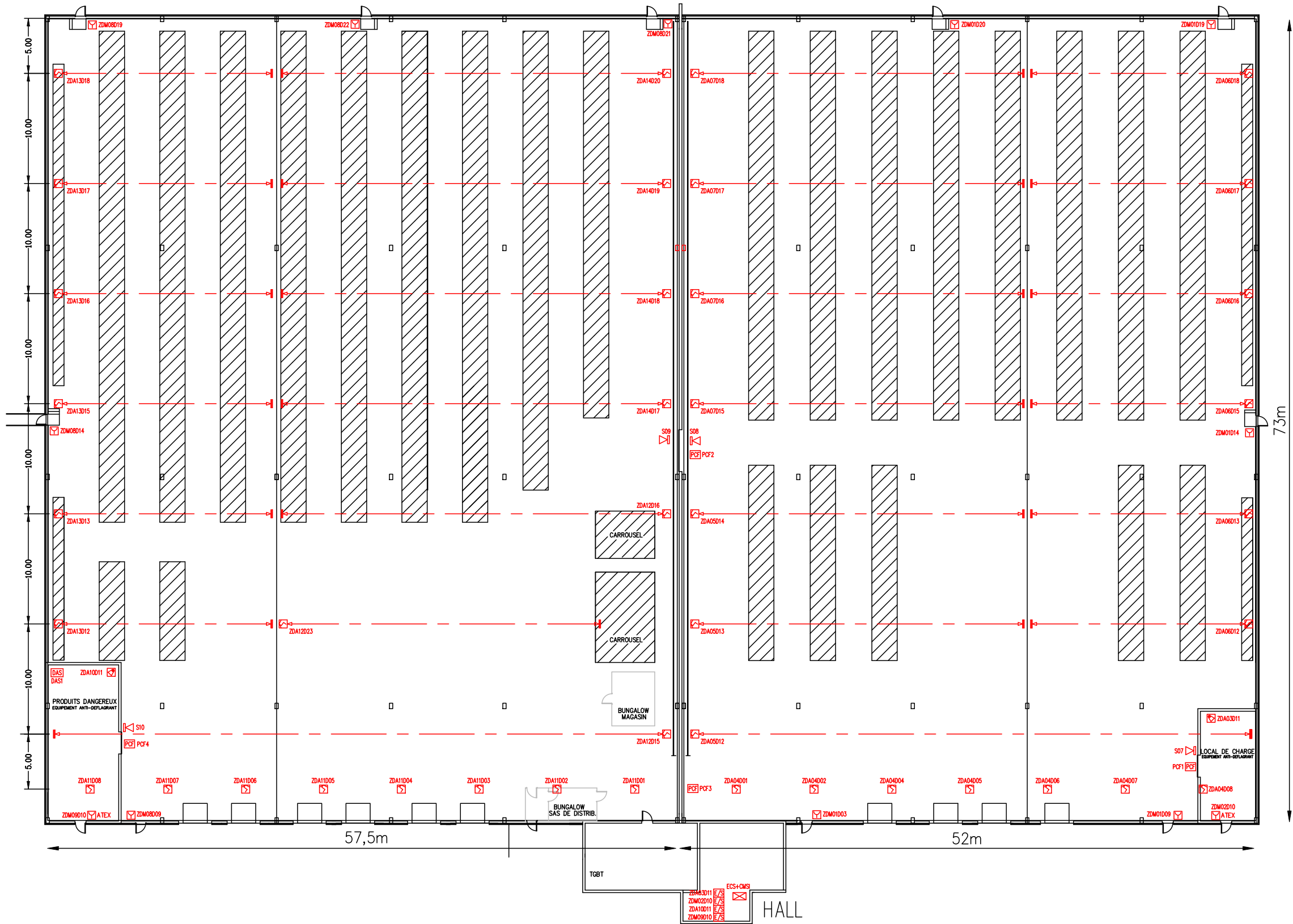

LEGENDE

- CENTRALE DETECTION ECS+CMSI
- DETECTEUR DE FUMEE SUR SOCLE
- DETECTEUR LINEAIRE DE FUMEE
- DECLENCHEUR MANUEL D'ALARME
- CAPTEUR DE FLAMME
- SIRENE D'ALARME EVACUATION
- INTERFACE ATEX
- VENTOUSE PORTE COUPE-FEU
- VENTOUSE CLAPET COUPE-FEU



N° DAO		KS01270C				ENTREPOTS CWM		
REV	DATE	DESIGNATION		PAR	VISA	DETECTION INCENDIE IMPLANTATION		
0	01.25	EMISSION ORIGINALE		IES	LD 0P02336			
1	11.25	TEL QUE CONSTRUIT		IES	LD 0P02336			
						N°	F°07	Rev 1

RDC HALL + TGBT

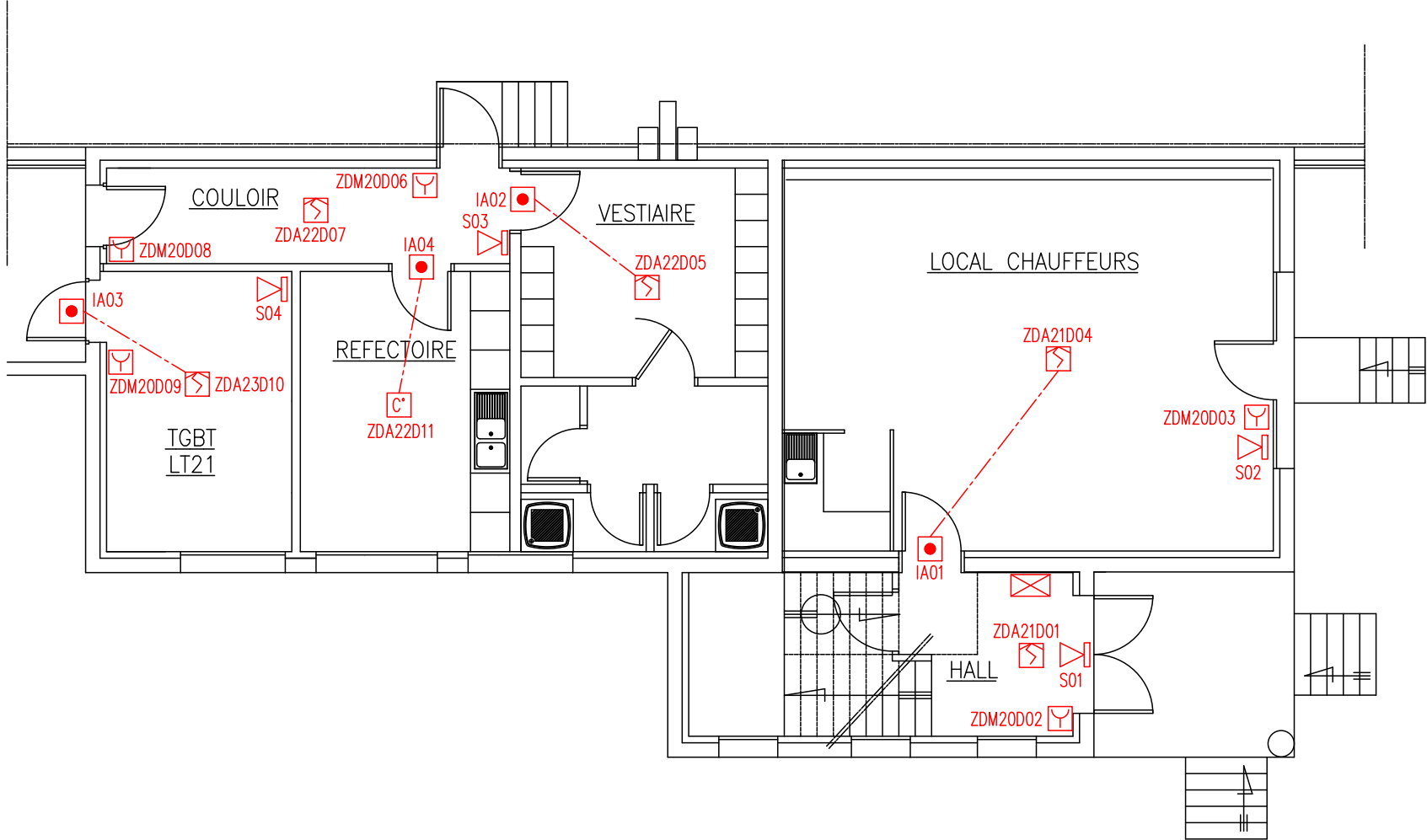

LEGENDE

- CENTRALE DETECTION ECS+CMSI
- DETECTEUR DE FUMEE
- DECLENCHEUR MANUEL D'ALARME
- DETECTEUR DE TEMPERATURE
- INDICATEUR D'ACTION
- DIFFUSEUR SONORE AVEC SOCLE





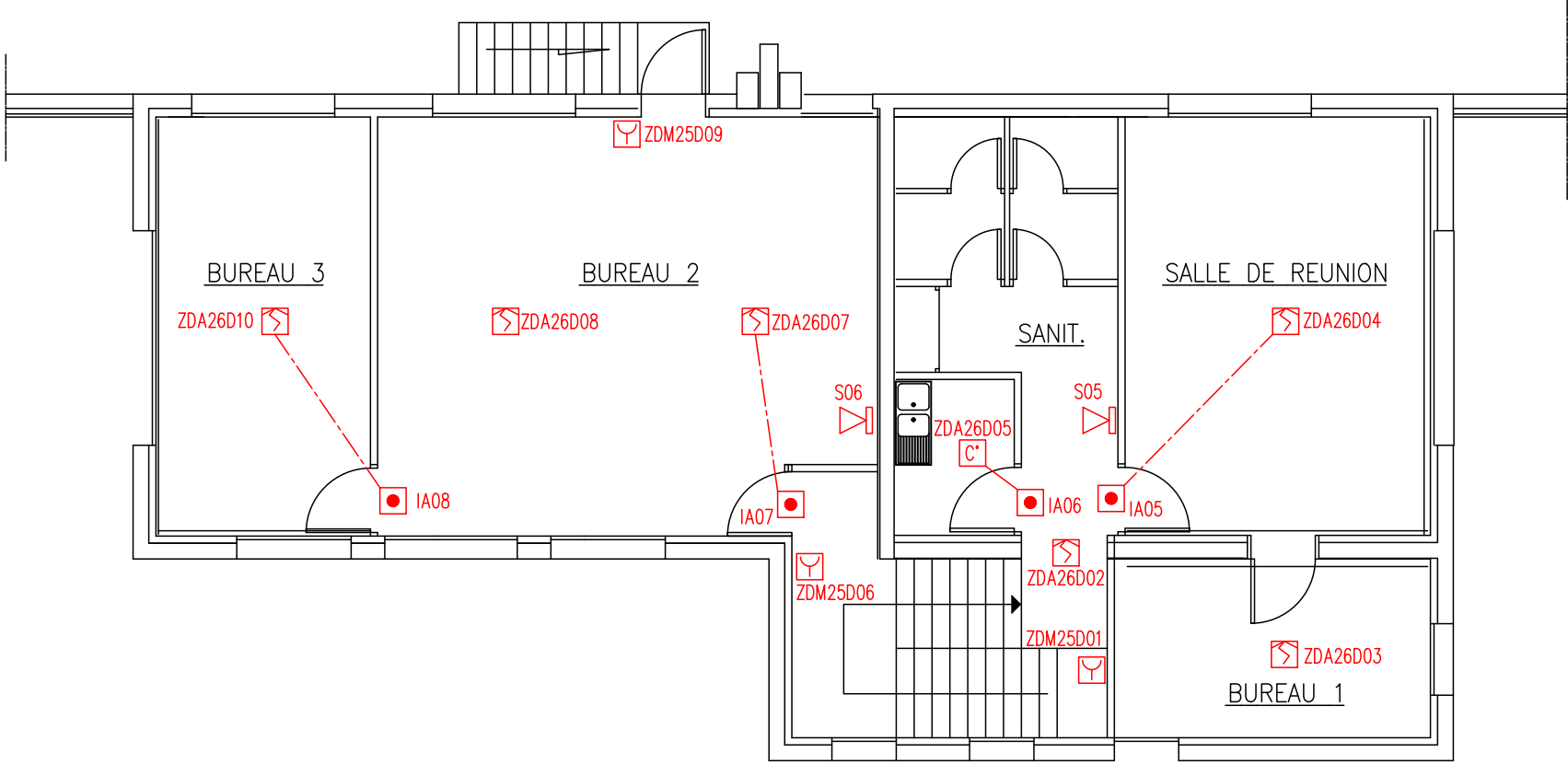

N° DAO		KS01271C			ENTREPOTS CWM		
REV	DATE	DESIGNATION	PAR	VISA	DETECTION INCENDIE RDC HALL + TGBT IMPLANTATION		
0	01.25	EMISSION ORIGINALE	IES	LD 0P02336			
1	11.25	TEL QUE CONSTRUIT	IES	LD 0P02336			
					N°	F°08	Rev 1

1ER ETAGE – BUREAUX



LEGENDE

-  DETECTEUR DE FUMEE
-  DECLENCHEUR MANUEL D'ALARME
-  DETECTEUR DE TEMPERATURE
-  INDICATEUR D'ACTION
-  DIFFUSEUR SONORE AVEC SOCLE



ExxonMobil
CBRE

N° DAO		KS01272C			ENTREPOTS CWM		
REV	DATE	DESIGNATION	PAR	VISA	DETECTION INCENDIE 1ER ETAGE – BUREAUX IMPLANTATION		
0	01.25	EMISSION ORIGINALE	IES	LD 0P02336			
1	11.25	TEL QUE CONSTRUIT	IES	LD 0P02336			
					N°		Rev 1

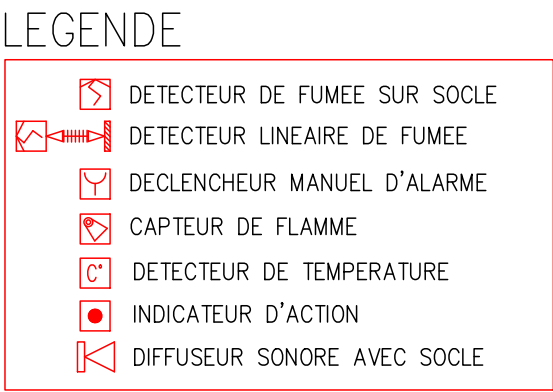

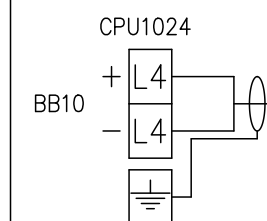

01IP09CR1C1
ZDA12D15

01IP09CR1C1
ZDA12D16

01IP09CR1C1
ZDA14D17

01IP09CR1C1
ZDA14D18

01IP09CR1C1
ZDA14D19

01IP09CR1C1
ZDA14D20





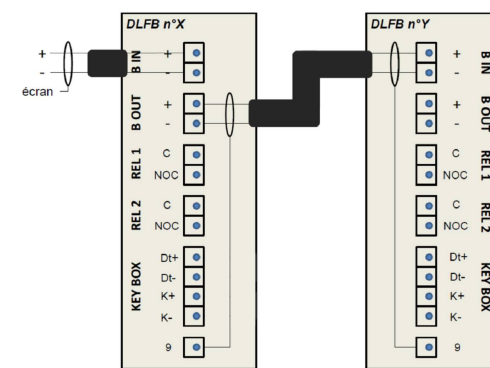
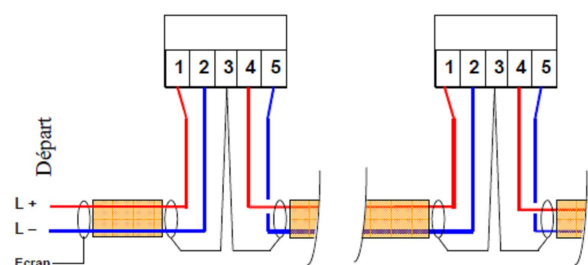

01IP09CR1C1
ZDM08D21

01IP09CR1C1
ZDM08D22

01IP09CR1C1
ZDA12D23

01IP09CR1C1
BUS 2



- | | |
|---|------------------------------|
|  | DETECTEUR DE FUMEE SUR SOCLE |
|  | DETECTEUR LINEAIRE DE FUMEE |
|  | DECLENCHEUR MANUEL D'ALARME |
|  | CAPTEUR DE FLAMME |
|  | DETECTEUR DE TEMPERATURE |
|  | INDICATEUR D'ACTION |
|  | DIFFUSEUR SONORE AVEC SOCLE |

DETECTEUR LINEAIRE DLFB100



ExxonMobil
CBRE

N° DAO		KS01274C			ENTREPOTS CWM		
REV	DATE	DESIGNATION	PAR	VISA	DETECTION INCENDIE SYNOPTIQUE DU BUS N°2 DI		
0	01.25	EMISSION ORIGINALE	IES	LD 0P02336			
1	11.25	TEL QUE CONSTRUIT	IES	LD 0P02336			
					N°	F°11	Rev 1

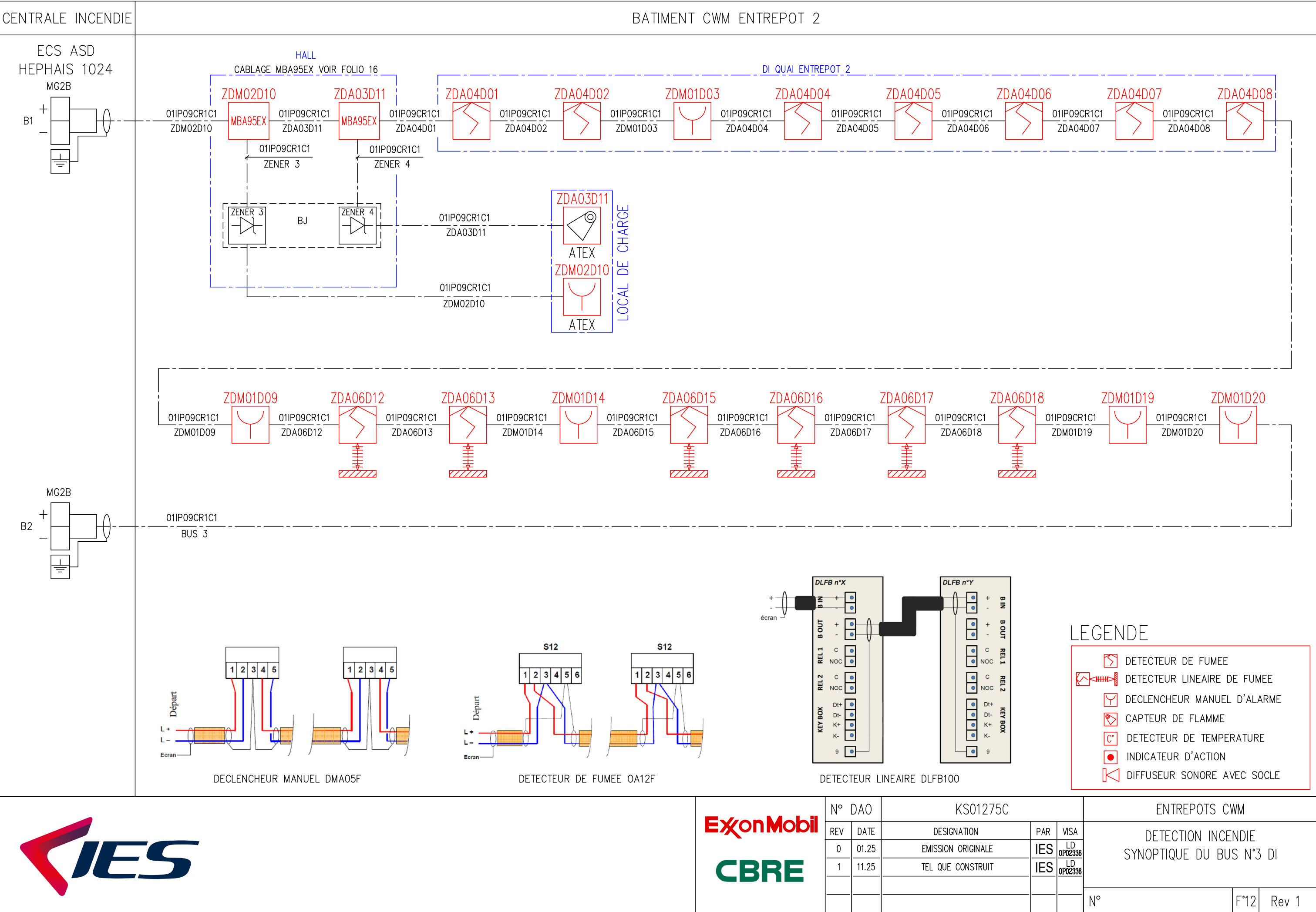

CENTRALE INCENDIE

BATIMENT CWM BUREAUX ETAGE

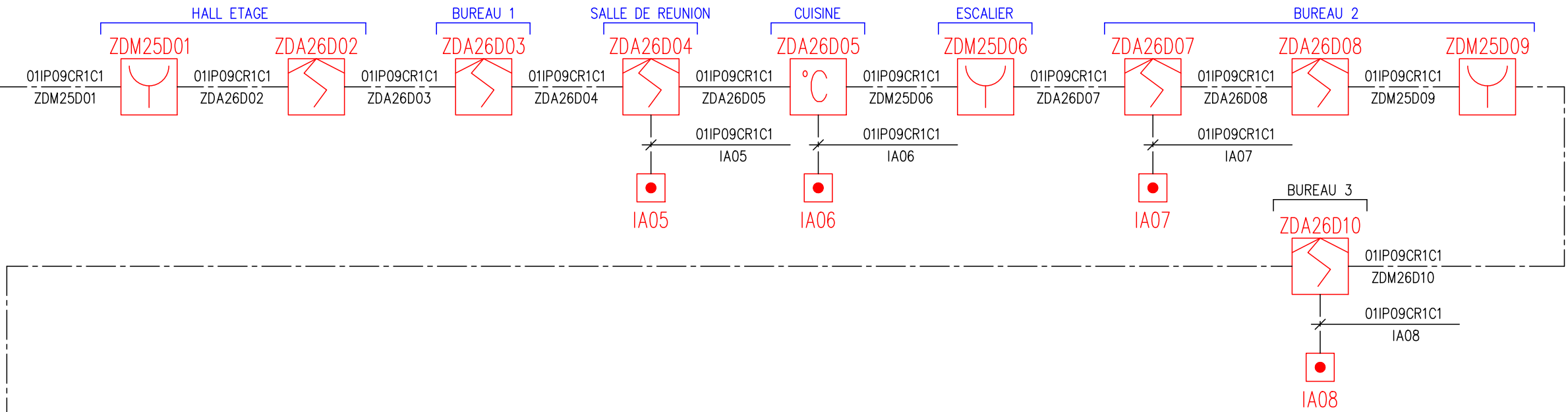
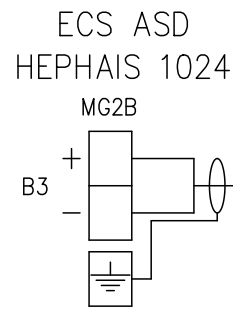

BATIMENT CWM ENTREPOT 2

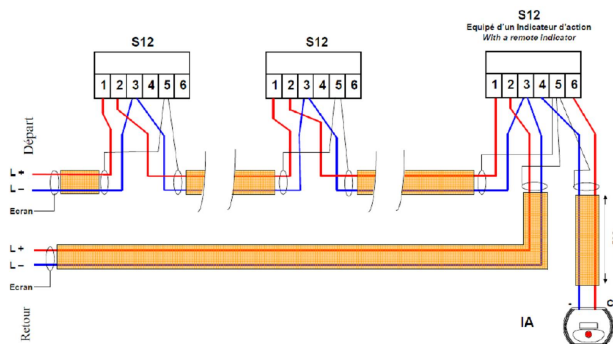
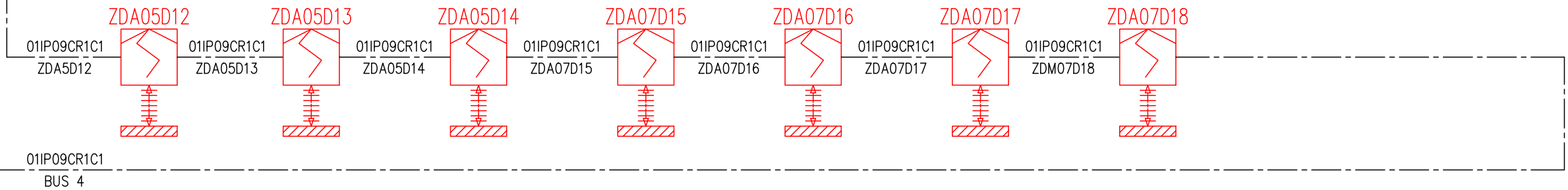
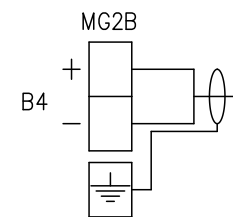

DETECTEUR DE FUMEE 0A12F

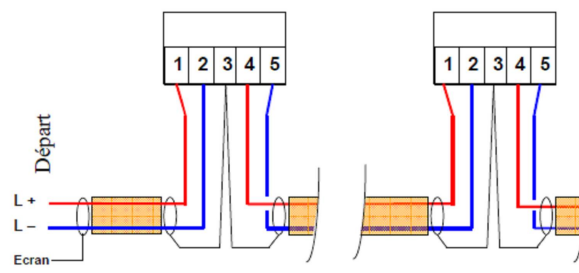



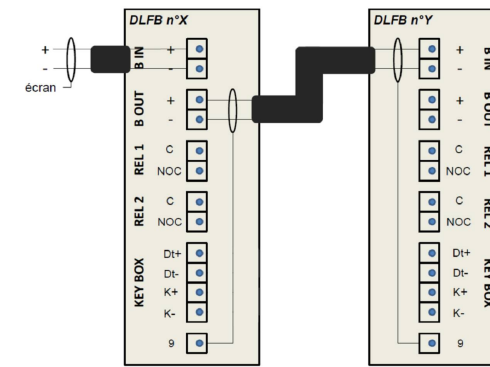



DECLENCHEUR MANUEL DMA05F



DETECTEUR LINEAIRE DLFB100

LEGENDE

- | | |
|---|-----------------------------|
|  | DETECTEUR DE FUMEE |
|  | DETECTEUR LINEAIRE DE FUMEE |
|  | DECLENCHEUR MANUEL D'ALARME |
|  | CAPTEUR DE FLAMME |
|  | DETECTEUR DE TEMPERATURE |
|  | INDICATEUR D'ACTION |
|  | DIFFUSEUR SONORE AVEC SOCLE |



ExxonMobil

CBRE

N° DAO		KS01276C			ENTREPOTS CWM			
REV	DATE	DESIGNATION	PAR	VISA	DETECTION INCENDIE SYNOPTIQUE DU BUS N°4 DI			
0	01.25	EMISSION ORIGINALE	IES	LD 0P02336				
1	11.25	TEL QUE CONSTRUIT	IES	LD 0P02336				
					N°		F°13	Rev 1

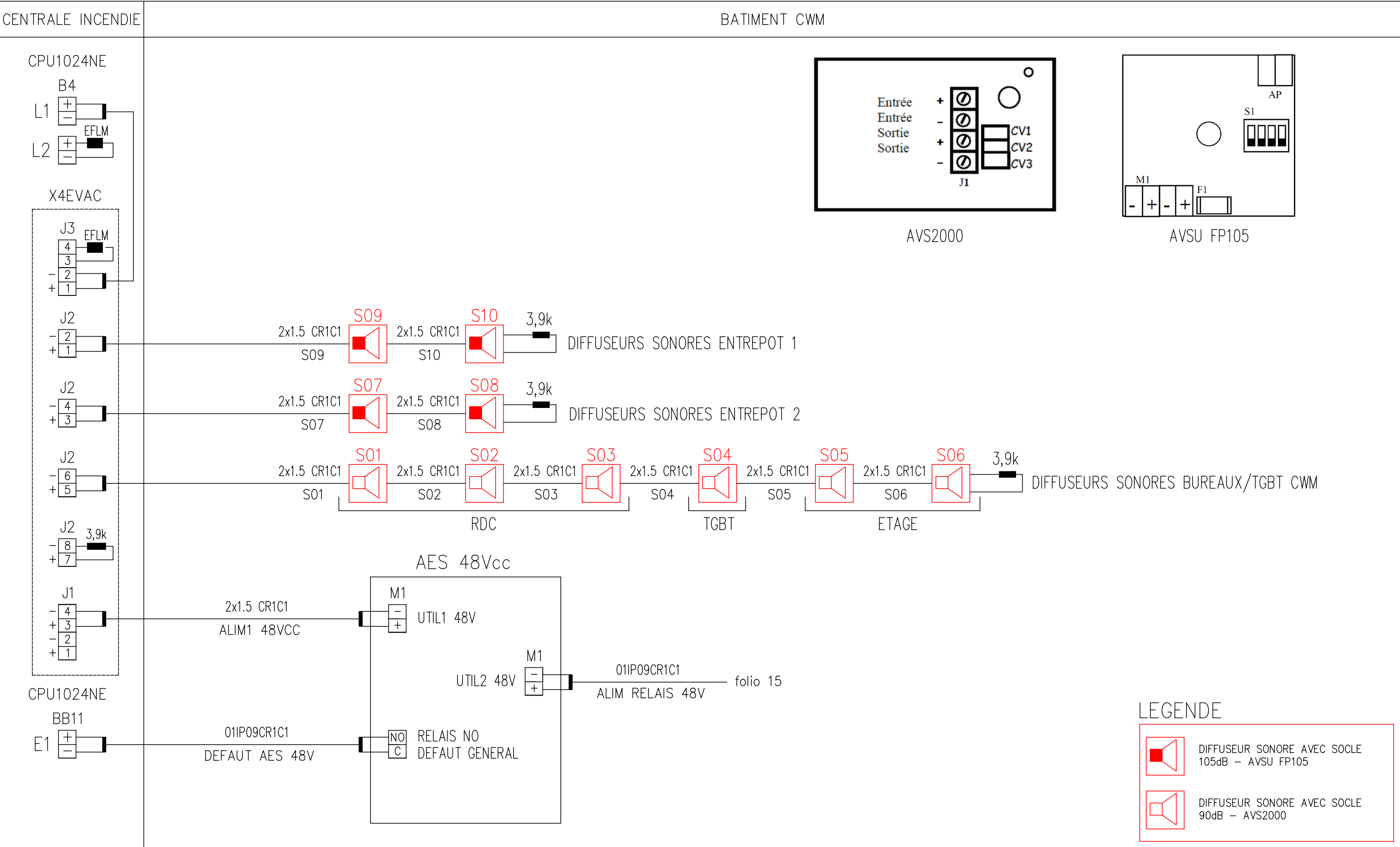

N° DAO		KS01277C			ENTREPOTS CWM			
REV	DATE	DESIGNATION	PAR	VISA	DETECTION INCENDIE AES – DIFFUSEURS SONORES			
0	01.25	EMISSION ORIGINALE	IES	LD 0P02336				
1	11.25	TEL QUE CONSTRUIT	IES	LD 0P02336				
					N°		F°14	Rev 1

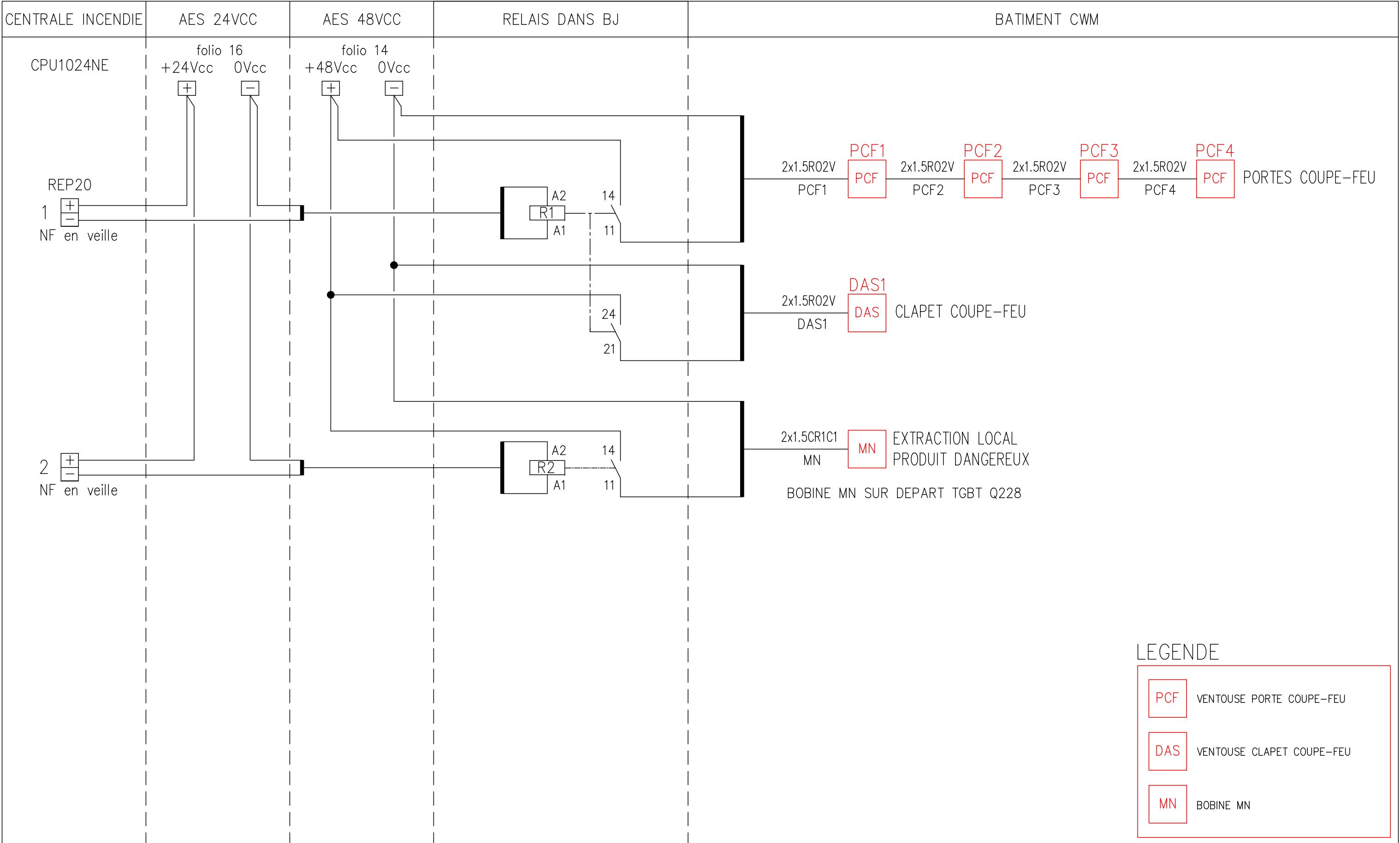

LEGENDE

PCF

VENTOUSE PORTE COUPE-FEU

DAS

VENTOUSE CLAPET COUPE-FEU

MN

BOBINE MN

BATIMENT CWM

CENTRALE INCENDIE

ZONE Saine AU DESSUS CENTRALE INCENDIE

ZONE ATEX – LOCAL PRODUITS DANGEREUX

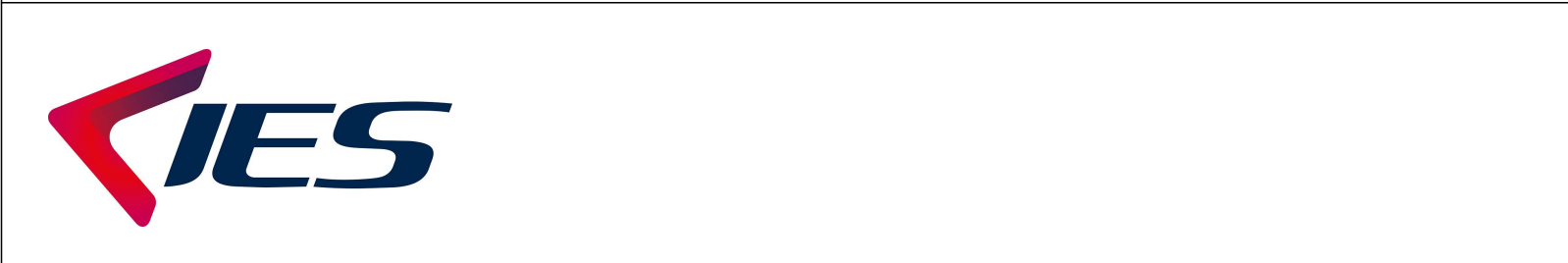
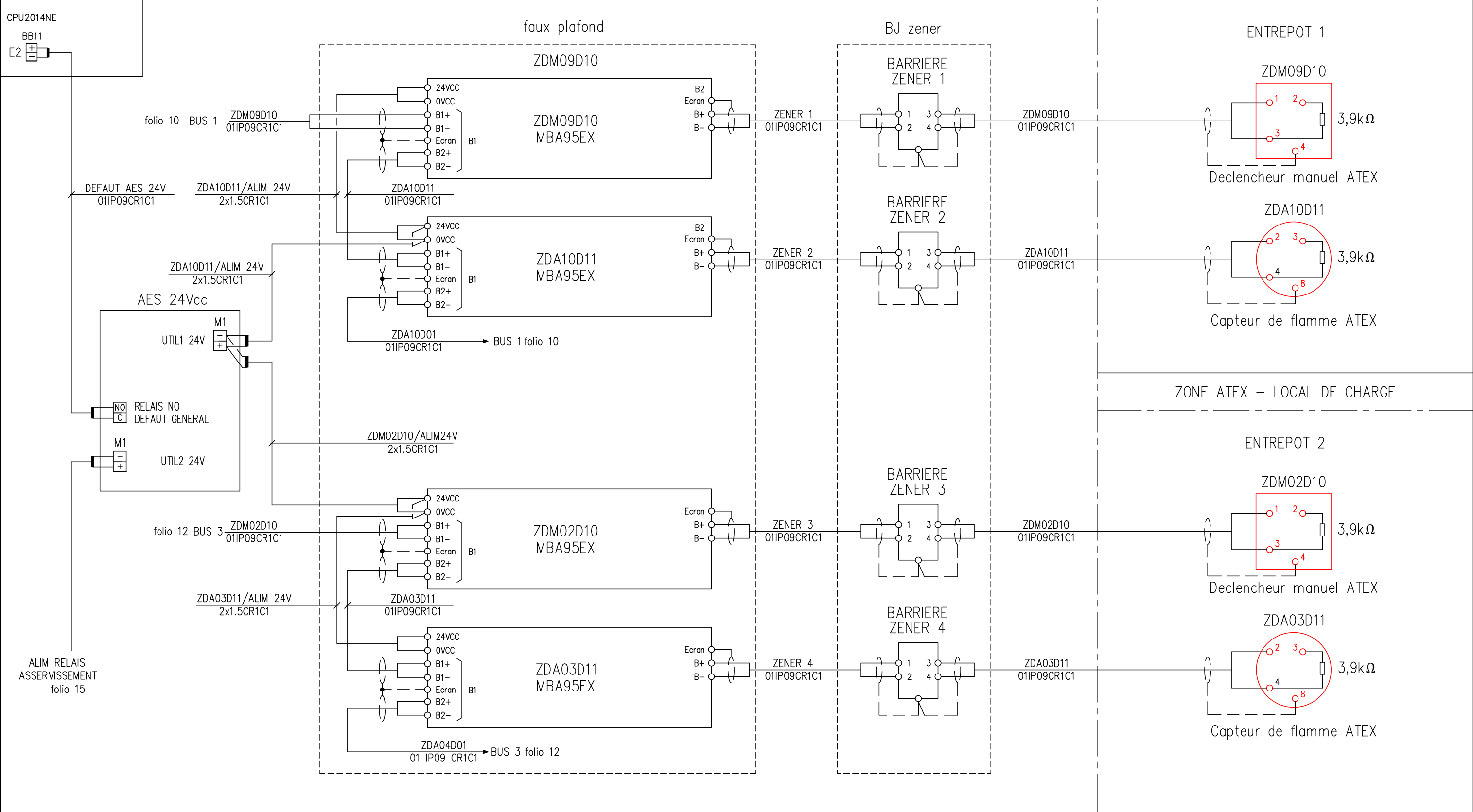

ExxonMobil
CBRE

N° DAO		KS01279C		
REV	DATE	DESIGNATION	PAR	VISA
0	01.25	EMISSION ORIGINALE	IES	LD OP02336
1	11.25	TEL QUE CONSTRUIT	IES	LD OP02336

ENTREPOTS CWM

<p>DETECTION INCENDIE</p> <p>RACCORDEMENT MATERIEL ATEX</p>

N°	F°16	Rev 1
----	------	-------

